

# EPC Cores

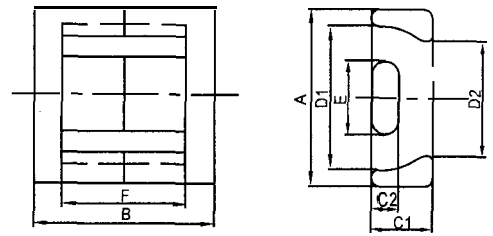

AL-Value(nH/N<sup>2</sup> ±25%): 1 kHz, 0.25v, 100Ts, 25 ±3<sup>0</sup>C

## 尺寸 (DIMENSIONS)

規格 (Type)	尺寸 (Dimensions) (unit: mm)							
	A	B	C1	C2	D1	D2	E	F
EPC10108	10.20±0.20	8.10f0.20	3.40±0.10	1.90±0.10	7.60min	5.30min	5.00±0.10	5.30±0.20
EPC13/13	13.30±0.30	13.20±0.40	4.60±0.15	2.05±0.10	10.50min	8.30min	5.60±0.15	9.00±0.40
EPC17/15	17.60±0.40	15.20±0.40	6.00±0.15	2.80±0.10	14.30min	11.50min	7.70±0.15	10.80±0.40
EPC17/17	17.60±0.40	17.10±0.40	6.00±0.15	2.80±0.10	14.30min	11.50min	7.70±0.15	12.10±0.40
EPC19/20	19.10±0.50	19.50±0.40	6.00k0.15	2.50f0.10	15.80min	13.10min	8.50±0.15	14.50±0.40
EPC19/20A	19.60±0.50	19.50±0.40	6.00±0.20	2.40±0.15	15.90min	12.90min	8.20±0.20	14.50±0.40
EPC25/25	25.10±0.50	25.00±0.40	8.00±0.20	4.00±0.10	20.65min	17.00min	11.50±0.20	18.00±0.60
EPC27/32	27.10±0.50	32.00±0.40	8.00±0.20	4.00±0.10	21.60min	18.50min	13.00±0.30	24.00±0.60
EPC30/35	30.10f0.50	35.00f0.40	8.00±0.20	4.00±0.10	23.60min	19.50min	15.00f0.30	26.00±0.60

## 磁芯參數及性能 (CORE SET PARAMETERS AND ELECTRICAL CHARACTERISTICS)

規格 (Type)	Le (mm)	Ae (mm <sup>2</sup> )	Cl (mm <sup>-1</sup> )	Ve (mm <sup>3</sup> )	材 料 Material				
					JPP-3	JPP-4	JPH-5	JPH-7	JPH-10
					AL	AL	AL	AL	AL
EPC10/08	17.8	9.39	1.9	167.1	1050	950			
EPC13/13	30.6	12.5	2.4	382.5	900	850			
EPC17/15	37.6	22.8	1.6	857.3	1350	1250			
EPC17/17	40.2	22.8	1.8	916.6	1250	1150			
EPC19/20	46.1	22.7	2.0	1046.5	980	900			
EPC19/20A	43.3	23.0	1.9	995.9	1250	1150			
EPC25/25	59.2	46.4	1.3	2746.9	1670	1550			
EPC27/32	73.1	54.6	1.3	3991.3	1780	1650			
EPC30/35	81.6	61.0	1.3	4977.6	1700	1550			